

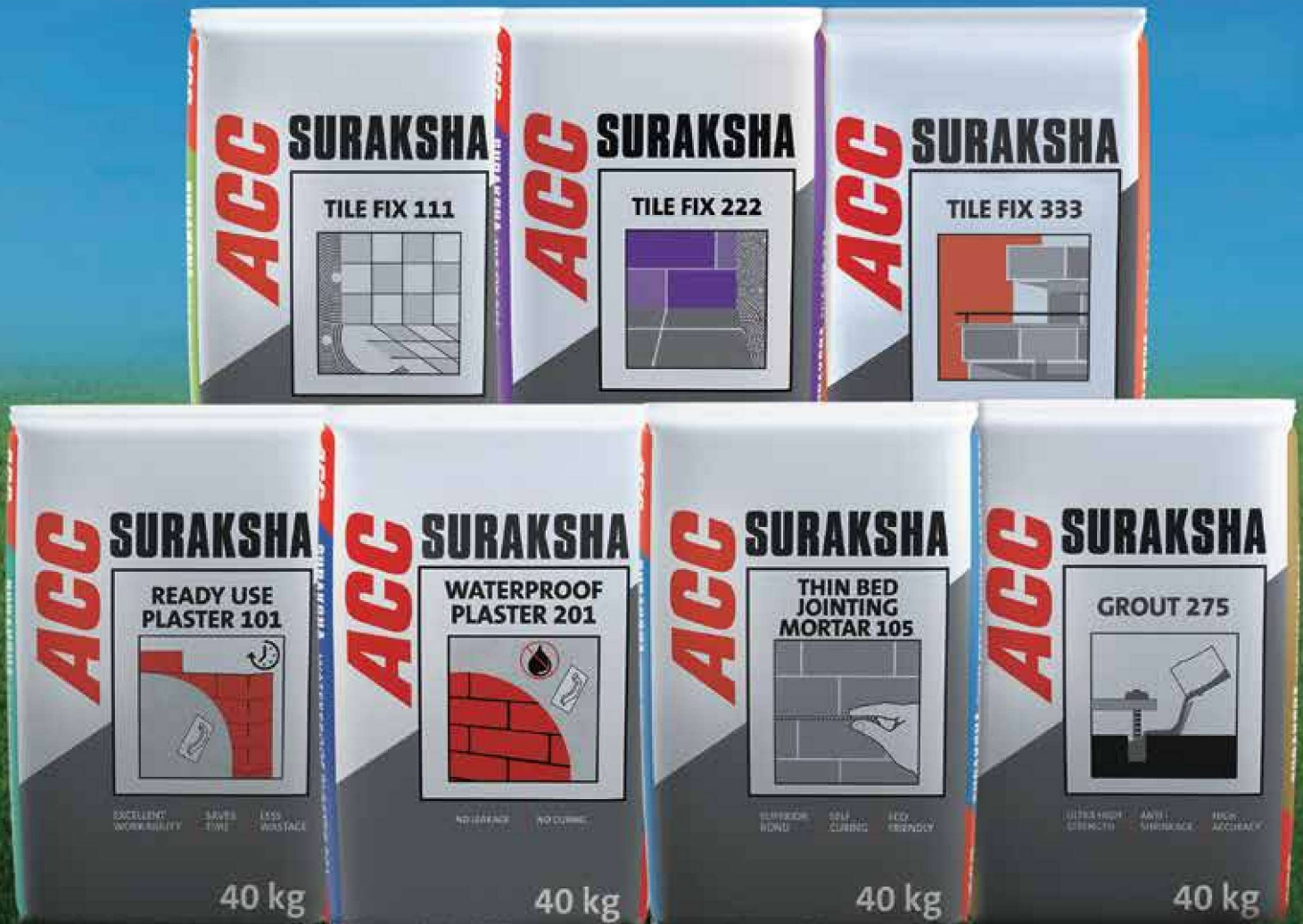

## PRODUCTS INFORMATION GUIDE





# **ACC SURAKSHA**

## **READY USE PLASTER 101**

ACC Suraksha Ready Use Plaster 101 is a carefully proportioned blend of high quality raw materials including well graded fine sand, ACC cement and special performance powder additives.

### **KEY FEATURES**

- Excellent workability & superior finish
- Superior quality
- Less wastage and better yield
- Less rebound loss
- Saves time

### **ADVANTAGES**

- High quality & easy storage
- Less wastage & minimization of losses
- Excellent workability
- Higher productivity & saves time

### **USES & APPLICATIONS**

All kinds of masonry and general purpose plastering works.



• External plastering of walls



• Internal plastering of walls & ceilings



• AAC block plastering work



• Other general purpose repair & patch work

## SURFACE PREPARATION, MIXING & APPLICATION

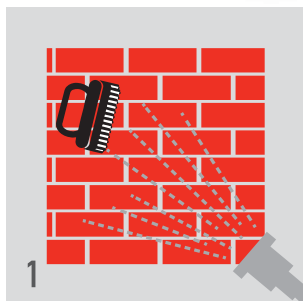

1  
Surface should be cleaned properly by removing all loose particles, oil grease etc. Surface needs to be pre-wetted with clean water.

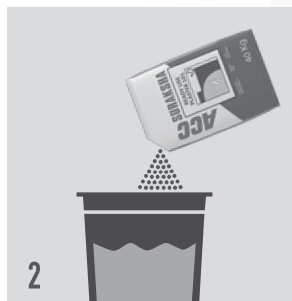

2  
Pour required quantity of ACC Suraksha Ready Use Plaster 101 into water (14-18%) to get desired consistency.

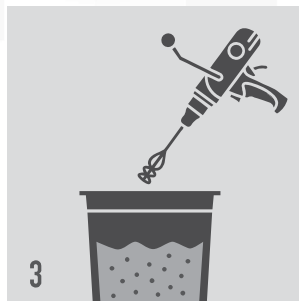

3  
For mixing use spiral mixer at low speed in a clean bucket. Mix well to obtain a lump-free smooth paste.

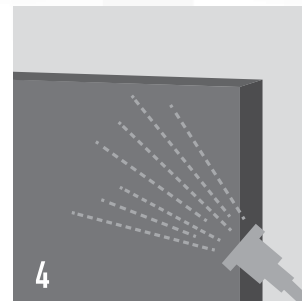

4  
Briefly stir the mixture before application & use this within pot life. Post application curing should be done for 3-4 days.

## TECHNICAL PROPERTIES

- Mixed density : 1.90-2.1 kg/ltr
- 28 Day comprehensive strength : 10-15 mpa
- Pot life : 30-50 minutes
- Bulk density : 1.6-1.8 kg/ltr
- Pull-out bond strength :  $\geq 0.5$  mpa
- Water-powder ratio : 14-18%

## COVERAGE

A 40kg bag of ACC Suraksha Ready Use Plaster 101 covers ~ 15-20 sq. ft. at coverage of 10 - 12 mm thickness. Coverage depends upon quality and nature of substrate being used.

## PACKAGING, SHELF LIFE & STORAGE

- Available in 40kg Ad Star bag
- 6 months from the date of manufacturing
- Store in a dry place away from moisture



# **ACC SURAKSHA**

## **WATERPROOF PLASTER 201**

ACC Suraksha Waterproof Plaster 201 is a ready to use cementitious waterproof mortar suitable for Internal & External plaster application. Its unique formula consists of ACC cement, well graded sand and special waterproofing and self-curing additives.

### **KEY FEATURES**

- Self curing
- Efflorescence resistance
- Less Rebound Loss
- High coverage
- Dual function plaster & Patch repair
- Excellent water resistance capability
- Higher bond Strength
- Saves Time/Cost
- Easy to use and apply, just add water

### **USES & APPLICATIONS**



- External plastering of walls



- Internal plastering of walls & ceilings



- Other general purpose repair & patch work



## SURFACE PREPARATION, MIXING & APPLICATION

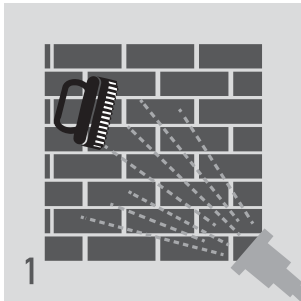

Surface should be cleaned properly by removing all loose particles, oil, grease etc. Surface needs to be pre-wetted with clean water.

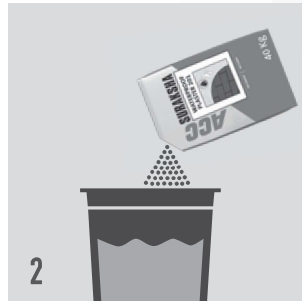

Pour required quantity of ACC Suraksha Waterproof Plaster 201 into water (12-14%) to get the desired consistency.

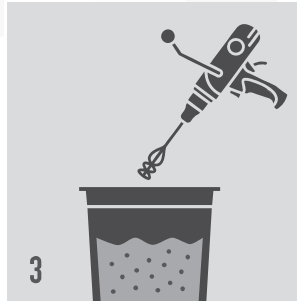

For mixing, use spiral mixer at low speed in a clean bucket. Mix well to obtain a lump-free smooth paste.

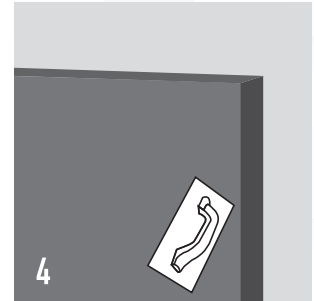

Briefly stir the mixture before application and use this within pot life.

## TECHNICAL PROPERTIES

- Mixed density : 1.8-1.95 Kg/ltr
- Bulk density : 1.60-1.8Kg/ltr
- 28 day compressive strength : 10-15Mpa
- Pull-out bond strength :  $\geq 0.5$  Mpa
- Pot life : 50-60 minutes
- Capillary absorption coefficient (Wc 2) :  $\leq 0.20 \text{ kg}/(\text{m}^2 \cdot \text{min}^{0.5})$
- W/P : 12-14%

Standard : EN 998-1;2017-02

## COVERAGE

A 40kg bag of ACC Suraksha Waterproof Plaster 201 covers ~ 20-24 sq. ft. at coverage of 10 - 12 mm thickness. Coverage depends upon quality and nature of substrate being used.

## PACKAGING, SHELF LIFE & STORAGE

- Available in 40kg Ad Star bag
- 6 months from the date of manufacturing
- Store in a dry place away from moisture



# **ACC SURAKSHA**

## **THIN BED JOINTING MORTAR (TBJM) 105**

ACC Suraksha TBJM 105 is a carefully proportioned cementitious mixture that is made of high quality and well graded sand, ACC Cement and special additives, which is used for fixing AAC / CLC / Fly-ash blocks etc. It is a self-curing polymer modified dry mortar.

### **KEY FEATURES**

- Ready to use, only water to be added
- Better bond than conventional cement based mortar
- Faster to apply due to good spreadable properties
- High strength & water retention properties

### **ADVANTAGES**

- High quality & easy storage
- Higher productivity & saves time
- Superior bond & self curing
- Eco friendly product

### **USES & APPLICATIONS**

All kinds of block masonry jointing works & all special architectural bricks jointing works.



• AAC blocks



• All special brick | Block masonry works

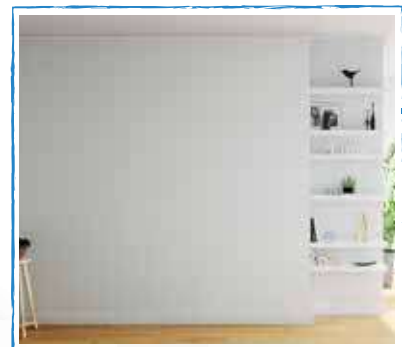

• Acoustic separating | Party walls | Flanking walls

## SURFACE PREPARATION, MIXING & APPLICATION

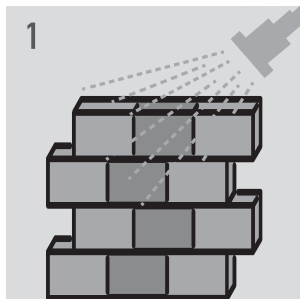

1  
AAC/CLC/Fly ash blocks should be cleaned well and the surface needs to be pre-wetted with clean water.

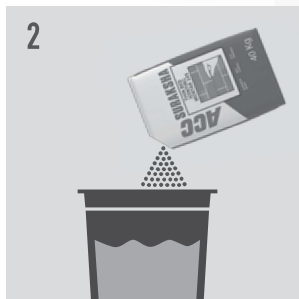

2  
Pour required quantity of ACC Suraksha Thin Bed Jointing Mortar 105 into water (22-25%) to get desired consistency.

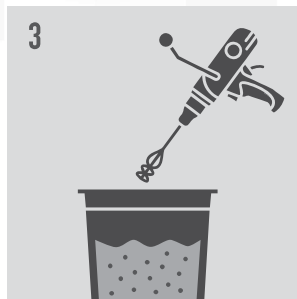

3  
For mixing use spiral mixer at low speed in a clean bucket. Mix well to obtain a lump-free smooth paste. After mixing leave the mix for 5 minutes.

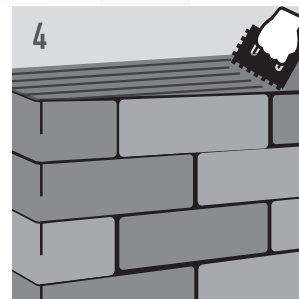

4  
Briefly stir the mixture before application. Apply ACC Suraksha Thin Bed Jointing Mortar 105 with a suitable notch trowel on the surface.

## TECHNICAL PROPERTIES

- Mixed density : 1.60-1.80 kg/ltr
- 28 day comprehensive strength : 5-7 mpa
- Pot life : 120-180 minutes
- Bulk density : 1.40-1.60 kg/ltr
- Pull-out bond strength :  $\geq 0.5$  mpa
- Water-Powder ratio : 22-25%

Parameter		Value
Splitting tensile strength	Dry condition (28days)	$\geq 0.35\text{N/mm}^2$

Standard : ASTM C 1660

## COVERAGE

A 40kg bag of ACC Suraksha TBJM 105 covers ~110-120 sq. ft. at coverage of 3 mm thickness.  
Coverage depends upon quality and nature of substrate being used.

## PACKAGING, SHELF LIFE & STORAGE

- Available in 40kg Ad Star bag
- 6 months from the date of manufacturing
- Store in a dry place away from moisture

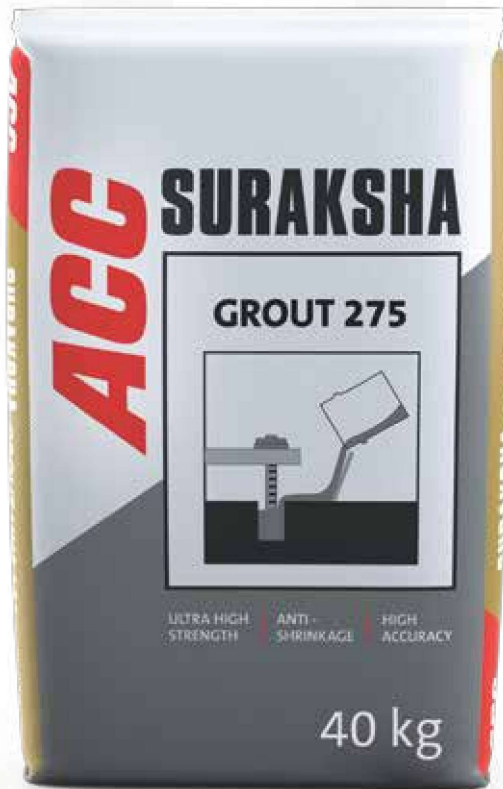

# **ACC SURAKSHA**

## **GROUT 275**

ACC Suraksha GROUT 275 is high strength, shrinkage compensated and flowable precision cementitious grout. It is designed for precision anchoring of machinery and metallic structure. This is best suited to withstand the static and dynamic load.

### KEY FEATURES

- Base plate grouting of machinery and equipment
- Anchoring of structural work
- Rigid joint filling between elements in concrete and pre-cast structures

### ADVANTAGES

- Ready to use, only water needs to be added
- High precision and anti-shrink
- High strength
- Excellent flowability

### USES & APPLICATIONS



• Heavy equipment & machines

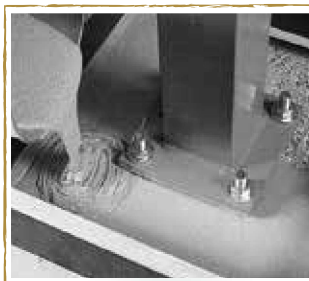

• Grouting & fixing



• Pre-cast



• Section enlargement



## SURFACE PREPARATION, MIXING & APPLICATION

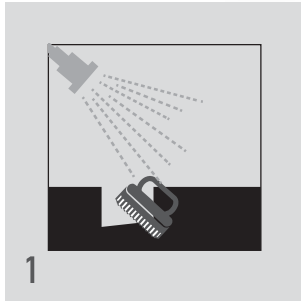

1  
Surface should be pre-wetted with clean water to remove all loose particles, oil, grease etc.

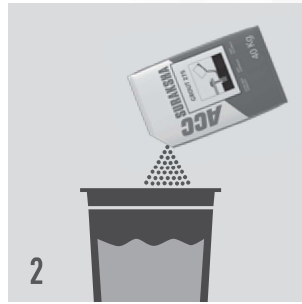

2  
Pour required quantity of ACC Suraksha Grout 275 into water (11-13%) to get desired consistency.

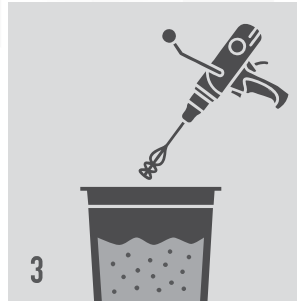

3  
For mixing use spiral mixer at low speed in a clean bucket. Mix well to obtain a lump-free smooth paste.

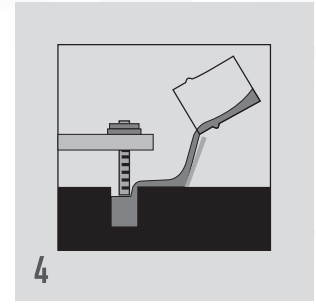

4  
Briefly stir the mixture prior to application and pour the mix continuously.

## TECHNICAL PROPERTIES

- Mixed density : 2100-2300 kg/ltr
- 28 day comprehensive strength : 70-75 mpa
- Pot life : 20-40 minutes
- Bulk density : 1.5-1.7 kg/ltr
- Pull-out bond strength :  $\geq 2.5$  mpa
- Water-powder ratio : 11-13%

Standard : ASTM C 1107

## YIELD

40Kg bag : 20-22 ltr

## PACKAGING, SHELF LIFE & STORAGE

- Available in 40kg Ad Star bag
- 6 months from the date of manufacturing
- Store in a dry place away from moisture

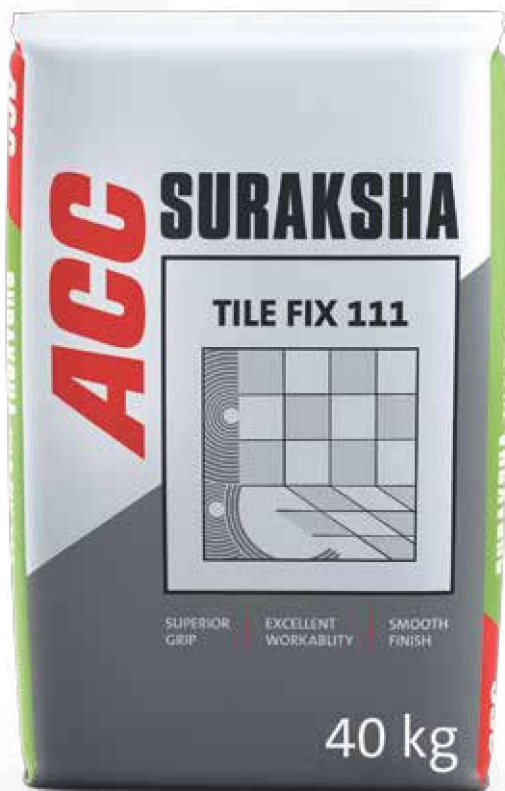

# **ACC SURAKSHA**

## **TILE FIX-111**

ACC Suraksha Tile Fix-111 is a ready to use grey cement based tile adhesive used for fixing small sized ceramic & mosaic tiles for internal application. (Both wall & floor.)

### KEY FEATURES

- Ready to use, only water to be added.
- Better bond than conventional cement based mortar
- Faster to apply due to good spreadable properties
- Excellent high strength & water retention properties
- Suitable for fixing small size ceramic & mosaic tiles on walls and floors

### ADVANTAGES

- High quality & easy to store dry pre-mixed powder
- Superior grip
- Excellent workability & smooth finish
- Higher productivity & saves time

### USES & APPLICATIONS



• For internal tiling application on walls



• For internal tiling application on floors



• Tile repairs & rehabilitation works

## SURFACE PREPARATION, MIXING & APPLICATION

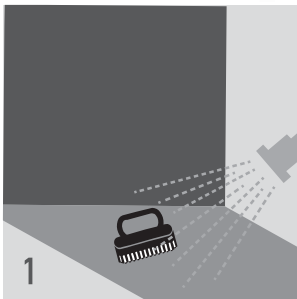

Surface should be cleaned properly by removing all loose particles, oil grease etc. Surface needs to be pre-wetted with clean water.

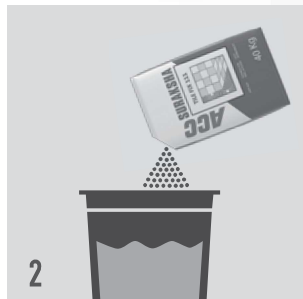

Pour required quantity of ACC Suraksha Tile Fix 111 into water (22-25%) to get desired consistency.

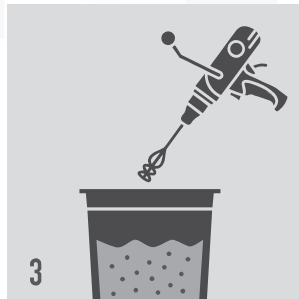

For mixing use spiral mixer at low speed in a clean bucket. Mix well to obtain a lump-free smooth paste. After mixing leave the mix for 5 minutes.

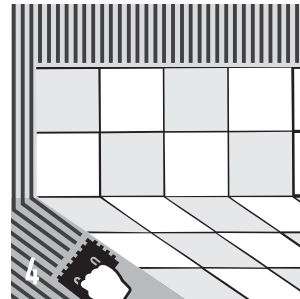

Briefly stir the mixture before application. Apply ACC Suraksha Tile Fix 111 with a suitable notch trowel on surface.

## TECHNICAL PROPERTIES

- Mixed density : 1.50-1.70 kg/ltr
- Bulk density : 1.40-1.60 mg/ltr
- Pot life : 120-180 minutes
- Open time : 10-20 minutes

Parameter		Value
Tensile adhesion	Dry condition	≥ 750N
	Wet condition	≥ 450N
Shear adhesion	Dry condition (24 Hrs)	≥ 2.50KN
	Dry condition (14 Days)	≥ 8.00KN
	Heat aging condition	≥ 4.00KN
	Wet condition	≥ 4.00KN

Standard : Type 1 as per IS15477-2004

## COVERAGE

A 40kg bag of ACC Suraksha Suraksha Tile Fix 111 covers ~ 110-120 sq. ft. at coverage of 3 mm thickness. Coverage depends upon quality and nature of substrate being used.

## PACKAGING, SHELF LIFE & STORAGE

- Available in 40kg Ad Star bag
- 6 months from the date of manufacturing
- Store in a dry place away from moisture



# **ACC SURAKSHA**

## **TILE FIX-222**

ACC Suraksha Tile Fix-222 is a ready to use grey cement based tile adhesive used for fixing medium size ceramic, mosaic & vitrified tiles for internal walls & floors and external floor application.

### KEY FEATURES

- Ready to use, only water needs to be added
- Excellent high strength & water retention properties
- Faster to apply due to good spreadable properties
- Suitable for fixing ceramic, mosaic & vitrified medium size tiles on walls & floors

### ADVANTAGES

- Comes with anti-slip properties
- Excellent workability & smooth finish
- Superior bond strength

### USES & APPLICATIONS



For internal tiling application  
on walls (Medium size)



For internal tiling application  
on floors (Medium size)



For external tiling application  
on floors (Medium size)



Tile-on-Tile applications

## SURFACE PREPARATION, MIXING & APPLICATION

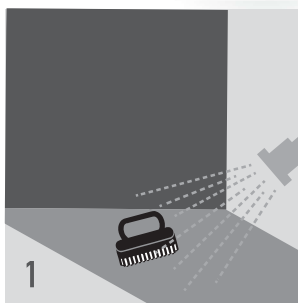

1  
Surface should be cleaned properly by removing all loose particles, oil grease etc. Surface needs to be pre-wetted with clean water.

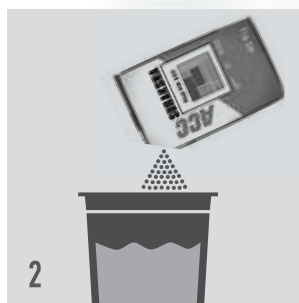

2  
Pour required quantity of ACC Suraksha Tile Fix 222 into water (22-25%) to get desired consistency.

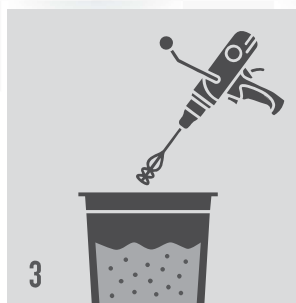

3  
For mixing use spiral mixer at low speed in a clean bucket. Mix well to obtain a lump-free smooth paste. After mixing leave the mix for 5 minutes.

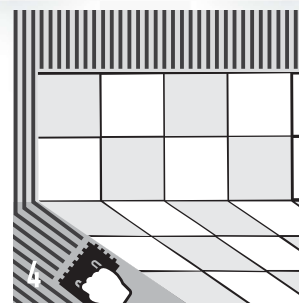

4  
Briefly stir the mixture before application. Apply ACC Suraksha Tile Fix 222 with a suitable notch trowel on surface.

## TECHNICAL PROPERTIES

- Mixed density : 1.50-1.70 kg/ltr
- Pot life : 180-240 minutes
- Bulk density : 1.40-1.60 kg/ltr
- Open time :  $\geq 20$  minutes

Parameter		Value
Shear adhesion	Dry condition (24 Hrs)	$\geq 4.000\text{KN}$
	Dry condition (14 Days)	$\geq 10.00\text{KN}$
	Heat aging condition	$\geq 5.00\text{KN}$
	Wet condition	$\geq 5.00\text{KN}$
Tensile adhesive strength	Dry condition (28days)	$\geq 0.5\text{N/mm}^2$
	Water immersion (28days)	$\geq 0.5\text{N/mm}^2$
	Heat aging (28days)	$\geq 0.5\text{N/mm}^2$
	Open time after 20 minutes	$\geq 0.5\text{N/mm}^2$

Standard : Type 2 Adhesive as per IS15477-2004 | C1T as per EN 12004

## COVERAGE

A 40kg bag of ACC Suraksha Tile Fix 222 covers ~ 110-120 sq. ft. at coverage of 3 mm thickness. Coverage depends upon quality and nature of substrate being used.

## PACKAGING, SHELF LIFE & STORAGE

- Available in 40kg Ad Star bag
- 6 months from the date of manufacturing
- Store in a dry place away from moisture



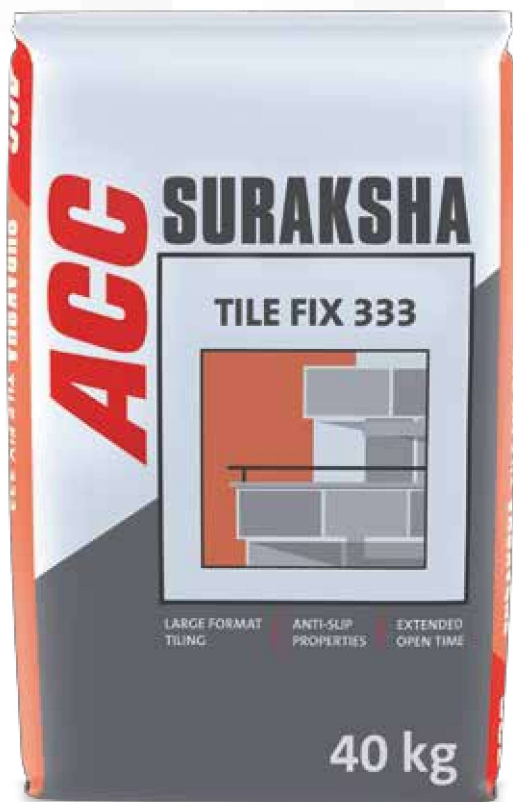

# **ACC SURAKSHA**

## **TILE FIX-333**

ACC Suraksha Tile Fix-333 is a ready to use grey cement based tile adhesive for fixing large format vitrified, ceramic mosaic tiles, stone, marbles & granite for internal and external, wall and floor applications.

### KEY FEATURES

- Ready to use, only water to be added
- Extended open time allows ease of application in external areas
- Excellent bonding strength & slip resistance provide good grip to large format tiles & stones

### ADVANTAGES

- Superior bond strength
- Enhances safety & durability of exterior tiles
- Excellent grip for large format tiles
- Better correction time during tile applications

### USES & APPLICATIONS



• Large format tile applications



• Marble / Granite applications



• Stone applications

## SURFACE PREPARATION, MIXING & APPLICATION

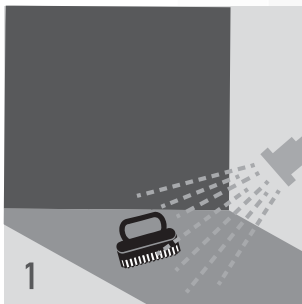

1  
Surface should be cleaned properly by removing all loose particles, oil, grease etc. Surface needs to be first moistened with clean water.

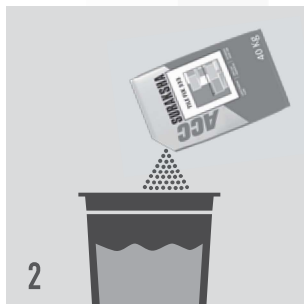

2  
Pour required quantity of ACC Suraksha Tile Fix 333 into water (24-27%) to get the desired consistency.

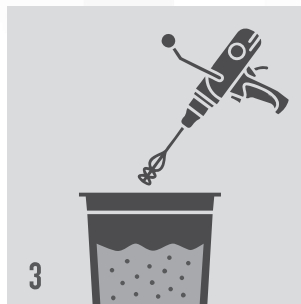

3  
For mixing, use spiral mixer at low speed in a clean bucket. Mix well to obtain a lump-free smooth paste. After mixing, leave the mix for 5 minutes.

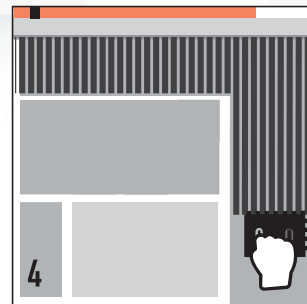

4  
Briefly stir the mixture before application. Apply ACC Suraksha Tile Fix 333 with a suitable notch trowel on the surface.

## TECHNICAL PROPERTIES

- Mixed density : 1.50-1.70 kg/ltr
- Pot life : 180-240 minutes
- Slip test (mm)  $\leq 0.5$
- Bulk density : 1.30-1.50 kg/ltr
- Open time :  $\geq 30$  minutes
- W/P : 24-27%

Parameter		Value
Shear adhesion	Dry condition (24 Hrs)	$\geq 4.000\text{KN}$
	Dry condition (14 Days)	$\geq 10.00\text{KN}$
	Heat aging condition	$\geq 5.00\text{KN}$
	Wet condition	$\geq 5.00\text{KN}$
Tensile adhesive strength	Dry condition (28days)	$\geq 1 \text{ N/mm}^2$
	Water immersion (28days)	$\geq 1 \text{ N/mm}^2$
	Heat aging (28days)	$\geq 1 \text{ N/mm}^2$
	Open time after 30 minutes	$\geq 0.5 \text{ N/mm}^2$

Standard : Type 2 Adhesive as per IS 15477 | C2TE as per EN 12004

## COVERAGE

A 40kg bag of ACC Suraksha Tile Fix 333 covers ~ 110-120 sq. ft. at coverage of 3 mm thickness. Coverage depends upon quality and nature of substrate being used.

## PACKAGING, SHELF LIFE & STORAGE

- Available in 40kg Ad Star bag
- 6 months from the date of manufacturing
- Store in a dry place away from moisture



***ACC***

**☎ 1800 1033 444**

**• CEMENT • READY MIX CONCRETE • BUILDING MATERIALS**

